

| | | | |
|------|------|-------------|----------|
| SIGN | DATE | DESCRIPTION | APPROVER |
| | | | |

THIS IS CAD DRAWING, DO NOT REVISE MANUALLY!!!

- Material**
- Terminal body (Contact pin): Brass
 - Wire guard: Stainless steel
 - Surface of solder tail: Tin plated
 - Insulator (housing): Thermoplastic (UL94V-0)
- Electrical**
- Voltage rating: 150VAC
 - Current rating: 2A
 - Wire range:
 - Solid wire(AWG): 20-26
 - Stranded wire(AWG): 20-26
 - Wire strip length: 9-10mm
 - Withstanding Voltage: 1.3KV
 - Operating temperature: -30°C to +105°C
 - Soldering temperature: 250°C±10°C/5 Sec

RoHS Compliant

PART NUMBER:

OSTHAXX5050

| | |
|--------------|---------------------|
| No. of Poles | COLOR |
| 02 2 Poles | 0: Black |
| 03 3 Poles | 2: Red |
| ... | 5: Green (Standard) |
| 24 24 Poles | 8: Grey |
| | C: Multiple Colors |

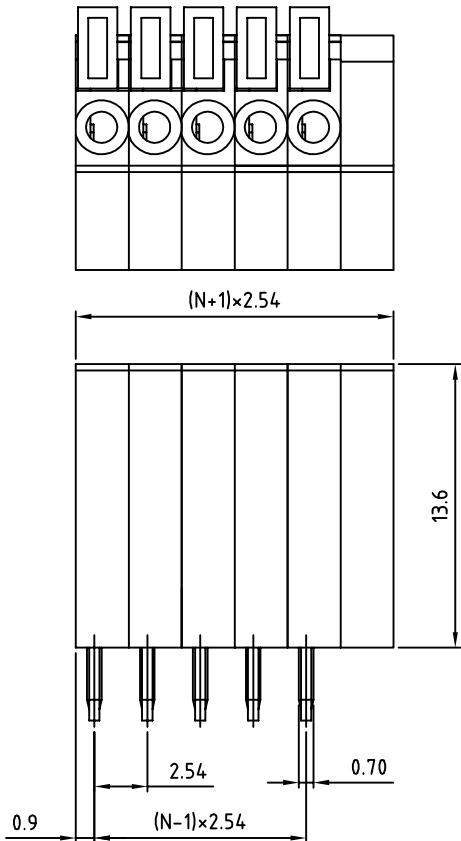

N=Number of contacts

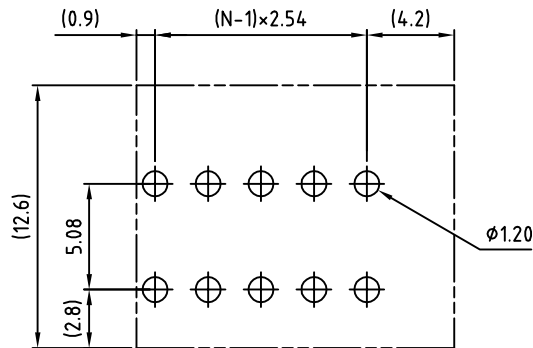
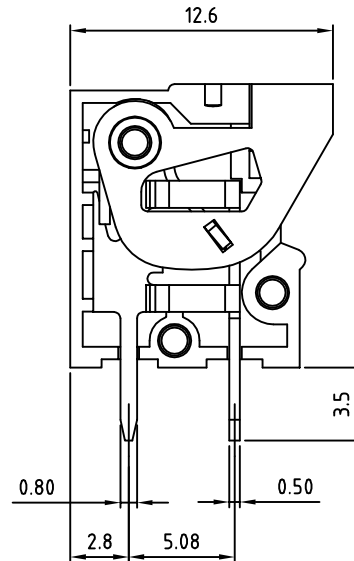

P.C.B. LAYOUT

THESE DRAWINGS AND SPECIFICATIONS ARE THE PROPERTY OF ON-SHORE TECHNOLOGY, INC. AND SHALL NOT BE REPRODUCED, COPIED OR USED IN ANY MANNER WITHOUT THE PRIOR WRITTEN CONSENT OF ON-SHORE TECHNOLOGY, INC.



| | | | | | | |
|-----------------------|----------------------|---|----------------------|--------------|--|-----------------|
| TITLE | | OSTHA-2.54mm series vertical (90° wire inlet) | | | | |
| PART NO. | | OSTHAXX5050 | | DWG NO. | | OSTHAXX5050.DWG |
| APPROVED | CHECKED | DESIGNED | DRAWN | CUST NO. | | Tolerance |
| Shi Jun 2006.11.01 | Marvin 2006.11.01 | Marvin 2005.09.08 | Marvin 2005.09.08 | | | X. ±0.50 |
| | | | | | | X.X ±0.30 |
| | | | | | | UNIT: mm |
| | | | | SHEET: 01/01 | | SCALE: NONE |
| | | | | REV.: C | | X° ±1° |